



KONICA MINOLTA

**bizhub** C3320i

Color A4 multifunctional

**bizhub  
i-SERIES IS  
SMARTER  
WORKING**  
RETHINK IT



Giving Shape to Ideas

## CUSTOMER BENEFITS



### Intuitive operability

Operate the bizhub like a smartphone or tablet with fully customised user interface



### Mobile connectivity

Print anytime from anywhere with Konica Minolta's innovative mobile technologies



### Security

Secure network integration, data encryption, hard drive overwrite, and advanced user authentication



### Services

Efficient printer fleet management, including automatic consumables delivery, pro-active maintenance and remote setup



### Sustainability

Numerous eco features reduce energy consumption and costs

## OPTIONS

### 1 ENHANCED FEATURES

Antivirus  
LK-116

### 2 CONNECTIVITY

Fax board  
FK-517

Wireless LAN  
UK-221

USB I/F kit  
EK-P08

USB I/F kit  
EK-P09

NFC kit  
EK-P10

I/F cable for CSRC modem  
EK-P11

Biometric authentication  
AU-102

ID card reader

Mount kit  
MK-P08

#### LEGEND

- Mandatory option
- Option
- This option can only be installed with the respective option above it

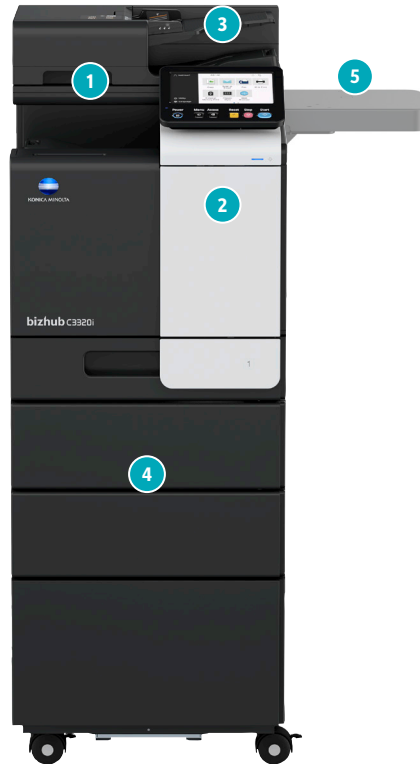

### 3 OTHERS

Working table  
WT-P03

10-Key pad  
KP-P03

Keyboard holder  
KH-P02

Air cleaning unit  
CU-102

Mount kit  
MK-P09

### 4 MEDIA INPUT

Paper tray  
PF-P20

Height adjustment unit  
PF-P22

Copy desk  
DK-P04x

### 5 MEDIA OUTPUT

Off-line stapler  
FS-P04

## FINISHING FUNCTIONALITIES



Duplex



Corner  
stapling  
(offline)

## DESCRIPTIONS

### ENHANCED FEATURES

LK-116 Antivirus	Bitdefender® Antivirus provides real time scanning of all incoming and outgoing data
------------------	--

### CONNECTIVITY

FK-517 Fax board	Super G3 fax; digital fax functionality
UK-221 Wireless LAN	Wireless LAN and wireless LAN Access Point Mode
EK-P08 USB I/F kit	USB keyboard connection
EK-P09 USB I/F kit	USB keyboard connection; Bluetooth
EK-P10 NFC interface	To connect with Android mobile devices
EK-P11 I/F cable for CSRC modem	GPRS modem connection for CSRC
AU-102 Biometric authenticaton	Finger vein scanner
ID card reader	Various ID card technologies
MK-P08 Mount kit	Installation kit for ID card reader

### OTHERS

WT-P03 Working table	Authentication device placement
KP-P03 10-Key pad	For use instead of touchscreen
KH-P02 Keyboard holder	To place USB keyboard
CU-202 Air cleaning unit	Improving indoor air quality by reduced emissions
MK-P09 Mount kit	Installation kit for Air cleaning unit

### MEDIA INPUT

PF-P20 Paper tray	500 sheets, A4, 60-90 g/m <sup>2</sup>
PF-P22 Height adjustment unit	To achieve comfortable height for operation
DK-P04x Copier desk	Provides storage space for print media and other materials

### MEDIA OUTPUT

FS-P04 Off-line stapler	20-sheet off-line stapling
-------------------------	----------------------------

## TECHNICAL SPECIFICATIONS

### SYSTEM SPECIFICATIONS

Panel size/resolution	7" / 800 x 480
System memory (standard/max)	4,096 MB
System hard drive	16 GB (standard)
Interface	10/100/1,000-Base-T Ethernet; USB 2.0; Wi-Fi 802.11 b/g/n (optional)
Network protocols	TCP/IP (IPv4/IPv6); SMB; LPD; IPP; SNMP; HTTP(S); AppleTalk; Bonjour
Automatic document feeder (standard)	Up to 80 originals; A6-A4; 50-128 g/m <sup>2</sup> ; Dualscan ADF
Paper input capacity (standard/max)	600 sheets / 1,100 sheets
Paper tray input (standard)	1x 500 sheets; A6-A4; custom sizes; 60-210 g/m <sup>2</sup>
Paper tray input (optional)	1x 500 sheets; A4; 60-90 g/m <sup>2</sup>
Manual bypass	100 sheets; A6-A4; custom sizes; 60-210 g/m <sup>2</sup>
Automatic duplexing	A4; 60-210 g/m <sup>2</sup>
Finishing modes (optional)	Group; Sort; Staple (offline)
Output capacity (standard)	Max. 250 sheets
Copy/print volume (monthly)	Rec. 6,500 pages; Max. <sup>1</sup> 96,000 pages
Toner lifetime	Black up to 13,000 pages CMY up to 9,000 pages
Imaging unit lifetime	Black up to 155,000 pages (imaging unit) CMY up to 55,000 pages (imaging unit)
Power consumption	220-240 V / 50/60 Hz; Less than 1.45 kW
System dimension (W x D x H)	420 x 528 x 572 mm (without options)
System weight	Approx. 38.4 kg (without options)

### PRINTER SPECIFICATIONS

Print resolution	1,800 (equivalent) x 600 dpi; 1200 x 1200 dpi
Page description language	PCL 6 (XL3.0); PCL 5c; PostScript 3 (CPSI 3016); XPS
Operating System	Windows 7 (32/64); Windows 8/8.1 (32/64); Windows 10 (32/64); Windows Server 2008 (32/64); Windows Server 2008 R2; Windows Server 2012; Windows Server 2012 R2; Windows Server 2016; Windows Server 2019; Macintosh OS X 10.10 or later; Unix; Linux; Citrix
Printer fonts	80 PCL Latin; 137 PostScript 3 Emulation Latin
Mobile printing	AirPrint (iOS); Mopria (Android); Konica Minolta Mobile Print (iOS/Android/Windows 10 Mobile); Mobile Authentication and Pairing (iOS/Android) Optional: WiFi Direct

### SCANNER SPECIFICATIONS

Scan speed (mono/colour)	Up to 28/28 ipm in simplex Up to 56/56 ipm in duplex
Scan modes	Scan-to-eMail (Scan-to-Me); Scan-to-SMB (Scan-to-Home); Scan-to-FTP; Scan-to-USB; Scan-to-WebDAV; Scan-to-URL
File formats	JPEG; TIFF; PDF; Compact PDF; Encrypted PDF; XPS; Compact XPS; PPTX
Scan destinations	2,100 (single + group); LDAP support

### COPIER SPECIFICATIONS

Imaging technology	Laser
Toner technology	Simitri® HD polymerised toner
Copy/print speed A4 (mono/colour)	Up to 33/33 ppm
Autoduplex speed A4 (mono/colour)	Up to 33/33 ppm
1 <sup>st</sup> copy out time A4	6.0/7.2 sec.
Warm-up time	Approx. 13 sec. in mono; 15 sec. in color <sup>2</sup>
Copy resolution	600 x 600 dpi
Gradation	256 gradations
Multicopy	1-9,999
Original format	A6-A4; Custom sizes
Magnification	25-400% in 0.1% steps; Auto-zooming

### FAX SPECIFICATIONS

Fax standard	Super G3 (optional)
Fax transmission	Analogue; i-Fax; Colour i-Fax; IP-Fax
Fax resolution	Up to 600 x 600 dpi
Fax compression	MH; MR; MMR; JBIG
Fax modem	Up to 33.6 Kbps
Fax destinations	2,100 (single + group)

## SYSTEM FEATURES

<b>Security Functions (standard)</b>	IP filtering and port blocking; SSL2; SSL3 and TLS1.0/1.1/1.2 network communication; IPsec support; IEEE 802.1x support; User authentication; Authentication log; Secure print; Kerberos; Hard drive data encryption (AES 256)
<b>Security Functions (optional)</b>	Antivirus realtime scanning (Bitdefender®)
<b>Accounting (standard)</b>	Up to 100 user accounts; Active Directory support (user name + password + e-mail + smb folder); User function access definition
<b>Accounting Functions (optional)</b>	Biometric authentication (finger vein scanner); ID card authentication (ID card reader); Authentication by mobile device (Android/iOS)
<b>Software</b>	Net Care Device Manager; Data Administrator; Web Connection; Print Status Notifier; Driver Packaging Utility; Log Management Utility

<sup>1</sup> If the maximum volume is reached within a period of one year, then a maintenance cycle must be performed

<sup>2</sup> Warm-up time may vary depending on the operating environment and usage

- All specifications refer to A4-size paper of 80 g/m<sup>2</sup> quality.
- The support and availability of the listed specifications and functionalities varies depending on operating systems, applications and network protocols as well as network and system configurations.
- The stated life expectancy of each consumable is based on specific operating conditions such as page coverage for a particular page size (5% coverage of A4). The actual life of each consumable will vary depending on use and other printing variables including page coverage, page size, media type, continuous or intermittent printing, ambient temperature and humidity.
- Some of the product illustrations contain optional accessories.
- Specifications and accessories are based on the information available at the time of printing and are subject to change without notice.
- Konica Minolta does not warrant that any specifications mentioned will be error-free.
- All brand and product names may be registered trademarks or trademarks of their respective holders and are hereby acknowledged.



Document imaging  
by Charles Kieffer Group

**Tél.** +352 26 380 1    **Fax** +352 26 380 380  
sales@ck-group.lu  
2, rue Léon Laval - Z.A. Am Bann  
L-3372 Leudelange  
**ck-documentimaging.lu**